

ANTİGRİZU KABLO RAKORLARI FIREDAMP CABLE GLANDS

E1WAS

Sınıflandırma / Classification

I M2 Ex d I Mb T6 - IP65

Standartlar / Standards

EN 60079-0 / EN 60079-1 / EN 60079-31

Sertifika No. / Certificate No.

SCA 12 ATEX 02XX / TSE 14.31.35-EX175



ZIRHLI KABLO İÇİN / FOR ARMoured CABLE

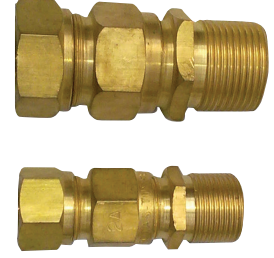
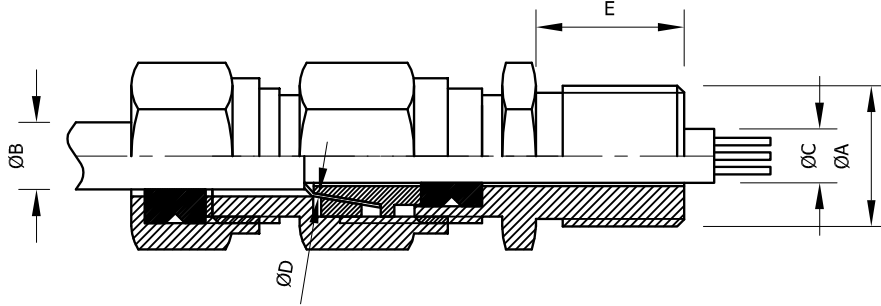

Rakor Tipi Gland Type	Ağırlık (kg) Weight	A		Bmax	Cmax	Dmax	E	Anahtar Ölçüsü Wrench Size
		NPT	METRIC					
E1WAS.1-A	0.33	1/2"	M20x1.5	10	8	1.5	22	AA 24
E1WAS.1-B	0.35	1/2"	M20x1.5	12	8	1.5	22	AA 24
E1WAS.1-C	0.38	1/2"	M20x1.5	14	10	1.5	22	AA 24
E1WAS.2-A	0.41	3/4"	M25x1.5	16	10	2.0	22	AA 27
E1WAS.2-B	0.44	3/4"	M25x1.5	18	12	2.0	22	AA 27
E1WAS.2-C	0.47	3/4"	M25x1.5	19	12	2.0	22	AA 30
E1WAS.2-D	0.48	3/4"	M25x1.5	22	14	2.0	22	AA 35
E1WAS.3-A	0.52	1"	M32x1.5	24	16	2.5	28	AA 35
E1WAS.3-B	0.55	1"	M32x1.5	26	16	2.5	28	AA 36
E1WAS.3-C	0.57	1"	M32x1.5	28	18	2.5	28	AA 36
E1WAS.3-D	0.58	1"	M32x1.5	30	20	3.0	28	AA 40
E1WAS.4-A	0.84	1 1/4"	M40x1.5	30	25	3.0	28	AA 45
E1WAS.4-B	0.91	1 1/4"	M40x1.5	35	28	3.0	28	AA 45
E1WAS.5-A	1.17	1 1/2"	M50x1.5	38	30	3.0	28	AA 50
E1WAS.5-B	1.24	1 1/2"	M50x1.5	42	35	3.0	28	AA 55
E1WAS.6-A	1.36	2"	M60x1.5	45	38	3.0	28	AA 60
E1WAS.6-B	1.41	2"	M60x1.5	50	42	3.0	28	AA 65
E1WAS.7-A	2.69	2 1/2"	M75x2	55	45	3.5	31	AA 80
E1WAS.7-B	2.78	2 1/2"	M75x2	62	50	3.5	31	AA 80
E1WAS.8-A	3.27	3"	M90x2.5	65	55	3.5	31	AA 95
E1WAS.8-B	3.32	3"	M90x2.5	70	60	3.5	31	AA 95
E1WAS.8-C	3.38	3"	M90x2.5	75	65	3.5	31	AA 95

Ölçüler mm'dir. / Dimensions in mm.

Malzeme : Pirinç / Material: Brass

Kaplama/Coating: Sarı - Çinko (Beyaz) - Nikel / Brass (Yellow) - Nickel Plated - Zinc Coated (White)